

Hurom™

p03 English

p14 Deutsch

p24 Français

p36 Español

p46 Italiano

p56 русский

p66 Polski

P.03-P.13 English

Instruction Manual | H-201 Series

[Home use only / Warranty not included]

P.14-P.23 Deutsch

Bedienungsanleitung | Serie H-201

[Nur für den privaten Gebrauch / Garantiekarte nicht eingeschlossen]

P.24-P.35 Français

Mode d'emploi | Série H-201

[Utilisation domestique uniquement / Garantie non incluse]

P.36-P.45 Español

Manual de instrucciones | Serie H-201

[Solo para uso doméstico / Garantía no incluida]

P.46-P.55 Italiano

Manuale di istruzioni | Serie H-201

[Solo per uso domestico / Garanzia non inclusa]

P.56-P.65 Русский

Руководство пользователя | H-201 Series

[Только для домашнего использования. Гарантия не включена]

P.66-P.75 Polski

Instrukcja użytkowania | Seria H-201

[Tylko do użytku domowego / Gwarancja nie jest wliczona w cenę]

IMPORTANT SAFEGUARDS ⁰³

WHEN USING ELECTRICAL APPLIANCES, BASIC SAFETY PRECAUTIONS SHOULD ALWAYS BE FOLLOWED INCLUDING THE FOLLOWING:

- 1. WHEN USING ELECTRICAL APPLIANCES, BASIC SAFETY PRECAUTIONS SHOULD ALWAYS BE FOLLOWED. READ ALL INSTRUCTIONS.**
- 2. TO PROTECT AGAINST RISK OF ELECTRICAL SHOCK, DO NOT PUT THE MAIN BODY (MOTOR) IN WATER OR ANY OTHER LIQUID.**
- 3. CLOSE SUPERVISION IS NECESSARY WHEN ANY APPLIANCE IS USED NEAR CHILDREN.**
- 4. UNPLUG FROM OUTLET WHEN NOT IN USE, BEFORE ASSEMBLING OR TAKING OFF PARTS AND BEFORE CLEANING.**
- 5. AVOID CONTACT WITH MOVING PARTS.**
- 6. DO NOT OPERATE ANY APPLIANCE WITH A DAMAGED CORD OR PLUG, OR AFTER THE APPLIANCE MALFUNCTIONS, OR IS DROPPED OR DAMAGED IN ANY MANNER. RETURN APPLIANCE TO THE NEAREST AUTHORIZED SERVICE FACILITY FOR EXAMINATION, REPAIR OR ELECTRICAL OR MECHANICAL ADJUSTMENT.**
- 7. THE USE OF ATTACHMENTS NOT RECOMMENDED OR SOLD BY THE MANUFACTURER MAY CAUSE FIRE, ELECTRIC SHOCK OR INJURY.**
- 8. DO NOT LET CORD HANG OVER EDGE OF TABLE OR COUNTER.**
- 9. ALWAYS MAKE SURE HOPPER IS SECURELY FASTENED IN PLACE BEFORE MOTOR IS TURNED ON. DO NOT UNFASTEN HOPPER WHILE JUICER IS IN OPERATION.**
- 10. BE SURE TO TURN SWITCH TO OFF POSITION AFTER EACH USE OF YOUR JUICER. MAKE SURE THE MOTOR STOPS COMPLETELY BEFORE DISASSEMBLING.**
- 11. DO NOT PUT YOUR FINGERS OR OTHER OBJECTS INTO THE JUICER WHILE IT IS IN OPERATION. IF FOOD BECOMES LODGED IN OPENING, USE FOOD PUSHER OR ANOTHER PIECE OF FRUIT OR VEGETABLE TO PUSH IT DOWN. WHEN THIS METHOD IS NOT POSSIBLE, TURN THE MOTOR OFF AND DISASSEMBLE JUICER TO REMOVE THE REMAINING FOOD.**
- 12. DO NOT USE OUTDOORS.**
- 13. DO NOT PLACE ON OR NEAR A HOT GAS OR ELECTRIC BURNER OR IN A HEATED OVEN.**
- 14. DO NOT USE APPLIANCE FOR OTHER THAN INTENDED USE.**

SAVE THESE INSTRUCTIONS

CONTENS

- P 04 1. Precautions for Safe Use**
- P 05 2. Cautions During Operation**
- P 06 3. Power Switch /
4. Precautions for Strainers**
- P 08 5. How to Assemble**
- P 09 6. Plugging and Unplugging Silicone**
- P 10 7. How to operate**
- P 11 8. When the squeezing screw stops
during normal operation**
- P 12 9. How to disassemble and clean**
- P 13 10. Before requesting repair**

Before Reading Manual

1. Read 'Precautions for Safe Use ' (p. 4~5) and use the appliance properly.
2. After reading the manual, keep it in a convenient location for future reference.
3. Do not use it abroad which has different power supply and voltage.
4. Any quality improvements is subject to change without notice.



1. Precautions for Safe Use

- 01 You should read <Precautions for Safe Use >
- 02 You should follow <Precautions for Safe Use >
- 03 Precautions are classified as follows.



Warning Violating the labeling requirement, may cause serious injury or death.

- DO NOT PLUG IN NOR UNPLUG WITH WET HANDS.
- USE THE RIGHT VOLTAGE ONLY AS SPECIFIED ON THE WARRANTY CARD AND THE PRODUCT SPECIFICATIONS. FAILURE TO FOLLOW THIS INSTRUCTION MAY RESULT IN ELECTRIC SHOCK, FIRE, OR PERFORMANCE IMPAIRMENT. Connecting to a different voltage may shorten the motor's lifespan or cause malfunction.
- PLUG THE POWER CORD CORRECTLY AND FIT IT TIGHTLY INTO A WALL SOCKET.
- IF THE POWER CORD IS DAMAGED, IT MUST BE REPLACED BY THE MANUFACTURER'S ITS SERVICE OR SIMILARLY QUALIFIED PERSONS IN ORDER TO AVOID A HAZARD. If the power cord is damaged, it may cause electric shock or fire.
- NEVER DISASSEMBLE CHAMBER SET PARTS OR INSERT ALIEN SUBSTANCES INTO THE JUICE OUTLET AND PULP

OUTLET WHILE THE JUICER IS RUNNING.

- WHEN THE POWER CORD, WIRE IS BROKEN OR DAMAGED OR THE PLUG-IN PART BECOMES LOOSE, DO NOT OPERATE THE MACHINE. IF THE SUPPLY CORD IS DAMAGED, IT MUST BE REPLACED BY THE MANUFACTURER, ITS SERVICE AGENT OR SIMILARLY QUALIFIED PERSONS IN ORDER TO AVOID A HAZARD.
- DO NOT WET OR SPLASH WATER ON THE MAIN BODY. Be careful not to let any liquids or other substances get into the switch on the appliance.
- DO NOT OPERATE THE POWER DIAL WITH WET HANDS.
- FOR SAFETY, GROUND THE APPLIANCE. (MAKE SURE TO USE THE OUTLET WITH GROUND CONNECTION.) DO NOT GROUND TO GAS PIPE, PLASTIC WATER PIPE, TELEPHONE LINE, AND SO FORTH. It could cause electric shock, fire, malfunction or explosion.
- NEVER DISASSEMBLE THE CHAMBER SET DURING OPERATION NOR INSERT FINGERS, FOREIGN OBJECTS SUCH AS FORKS, SPOONS, ETC. INTO HOPPER CHUTE OR JUICE OUTLET.
- APPLIANCES CAN BE USED BY PERSONS WITH REDUCED PHYSICAL, SENSORY OR MENTAL CAPABILITIES OR LACK OF EXPERIENCE AND KNOWLEDGE IF THEY HAVE BEEN GIVEN SUPERVISION OR INSTRUCTION CONCERNING USE OF THE APPLIANCE IN A SAFE WAY AND IF THEY UNDERSTAND THE HAZARDS INVOLVED. CHILDREN SHALL NOT PLAY WITH THE APPLIANCE. CLEANING AND USER MAINTENANCE SHALL NOT BE MADE BY CHILDREN. THIS APPLIANCE SHALL NOT BE USED BY CHILDREN. KEEP THE APPLIANCE OUT OF REACH OF CHILDREN.
- DO NOT USE THE PRODUCT WHILE WEARING OR CARRYING ITEMS WITH MAGNETIC FORCE (E.G., MAGNETIC BRACELETS, ETC.). Placing objects with magnetic force around the product may lead to malfunctions.



Caution Violating the labeling requirement, may cause serious injury or damage to the appliance.

- DO NOT RUN THE JUICER WHILE THE CHAMBER SET IS NOT ASSEMBLED PROPERLY.
- WHEN DETECTING A GAS LEAK, DO NOT INSERT THE POWER CORD INTO THE OUTLET. OPEN THE WINDOW TO VENTILATE FULLY AND IMMEDIATELY.
- NEVER INSERT UTENSILS SUCH AS CHOPSTICKS OR SPOONS INTO THE JUICE/PULP VENT.
- IF THE SCREW STOPS ROTATING DURING OPERATION, TURN THE DIAL TO THE [REV] DIRECTION FOR 3 TO 5 SECONDS TO ACTIVATE THE REVERSE OPERATION. ONCE THE REVERSE OPERATION STOPS COMPLETELY, TURN THE DIAL TO [ON] DIRECTION AGAIN.

If the screw continues to stop during the operation, the parts may be damaged or performance may be impaired due to overheating in the motor. When such a problem continues, stop using the product and contact our

local customer service center:

- **DURING THE OPERATION, DO NOT ATTEMPT TO MOVE THE MAIN BODY, DISASSEMBLE THE CHAMBER SET OR PARTS, OR TRY TO LOCK THEM.** It may cause an injury or a failure. If any action is needed, switch off and unplug the power cord first.
- **MAKE SURE NO ALIEN SUBSTANCES GET INTO THE HOPPER OTHER THAN INGREDIENTS WHEN USING THE JUICER.**
- **PLACE THE APPLIANCE ON A FLAT AND STABLE SURFACE.**
- **DO NOT OPERATE THE APPLIANCE FOR MORE THAN 30 MINUTES AT A TIME.** It may cause a motor failure due to overheating. Cool it down sufficiently about 5 minutes and operate it again.
- **DO NOT ALLOW A SEVERE SHOCK TO THE APPLIANCE NOR DROP IT.**
- **IF THE APPLIANCE GIVES OFF AN UNPLEASANT SMELL, EXCESSIVE HEATING, OR SMOKE, STOP USING THE APPLIANCE IMMEDIATELY AND CONTACT THE LOCAL CUSTOMER CARE CENTER.** When using a new appliance, it gives off a smell, which disappears naturally over time.
- **ALWAYS UNPLUG THE APPLIANCE AFTER USE. ALWAYS DISCONNECT THE APPLIANCE FROM THE POWER SOURCE IF IT IS LEFT UNATTENDED AND BEFORE ASSEMBLING, DISASSEMBLING OR CLEANING. WHEN UNPLUGGING THE POWER CORD, MAKE SURE TO HOLD THE POWER CORD BY ITS HEAD.**
- **DO NOT WASH THE APPLIANCE AT A HIGH TEMPERATURE, 80°C (176°F) OR HIGHER. DO NOT PUT THE APPLIANCE IN A DISHWASHER, A DRYER OR A MICROWAVE ETC.**
- **THE MACHINE WEIGHS ABOUT 5.7kg. WHEN YOU ARE MOVING THE MACHINE, MAKE SURE YOU HOLD THE MAIN BODY TIGHTLY WITH BOTH HANDS.** When you hold the machine by the chamber or the side of the main body, the main body may fall and result in injury or malfunction.
- **DO NOT USE HOUSEHOLD PRODUCTS FOR COMMERCIAL PURPOSE.** Forcing a large amount of ingredients for extraction may damage the parts. Please contact the Customer Service Center for the advice on using the product for commercial purposes.
- **DO NOT USE THE APPLIANCE IF THE ROTATING SIEVE OR THE PROTECTING COVER IS DAMAGED OR HAS VISIBLE CRACKS.**
- **EXCLUSIVELY FOR HOUSEHOLD USED ONLY**



2. Cautions during Operation

- **Make sure to properly read the instructions for preparing ingredients before inserting them.**
 - Poorly prepared ingredients may hinder the extraction process and/or cause damage to the product.
- **Ingredients that need extra care**
 - When using soft ingredients alone, such as mangoes,

bananas, or strawberries, the juice may pool inside the chamber and not be extracted properly. Please add other ingredients that are not too soft.

-For walnuts, peanuts, almonds, sunflower seeds, pine nuts, beans, etc., insert only a small amount or use them with other ingredients after steeping in water.

● Ingredients that cannot be juiced

- Do not use unjuiceable ingredients such as sesame seeds, coffee beans, tree barks, or Chinese peppers. Do not insert mudfish, eel, shrimp, marsh snail, squid, etc.
- Do not use fruits soaked in alcohol, honey, or sugar (e.g., grapes, raspberries, or mulberries) and herbal ingredients (e.g., glasswort or rock pine enzymes).
- Do not use any ingredients that are unjuiceable in nature, such as autumn olive, aloe, cactus, quince, banana, yam, kudzu root, sugar cane, acorn, and dandelion.
- Do not use boiled ingredients such as boiled potato, boiled sweet potato, and boiled bean. Do not use this product for grinding grains.
- Do not use frozen ingredients for juicing.

● **We recommend that you consume the juice immediately, if possible, and not refrigerate it over a long period of time.**

● **Do not use this product for grinding grains. (Failure to follow this instruction may cause malfunction or damage to the product.)**

* Do not re-squeeze pulp discharged through the pulp outlet.

* Do not idle the product before inserting ingredients.

● **Do not overload ingredients into the hopper above the guided limit mark.**

* Do not use for more than 30 minutes in a continuously.

- It may cause a failure due to the overheating of the motor. When using the appliance continuously, stop for 5 minutes after every 30 minutes of use.

* Never insert chopsticks or spoon into pulp outlet during the operation.

- Inserting chopsticks and the like may cause damage to parts and personal injury.

* Do not press the ingredients with anything except the pusher.

- It may stick to the screw and cause injury and failure.

* Do not operate the power dial with a wet hand

- It can cause electric shock, short circuit, or fire. Do not stain the power dial and its proximity with alien substances.

● **Keep the juice cap open while juicing, and empty the pulp container frequently when juicing several times or in bulk.**

- Juice or pulp may overflow the container. The juice can flow backwards into the hopper if the juice cap is closed.

* If you do not wash immediately after use, it may be caked with pulp, which makes it difficult to disassemble and wash or may become the cause of performance degradation.

06 3. Power Switch

Turn the dial to the left or right for operation.



[ON] : ON - Starts the motor and makes juice.

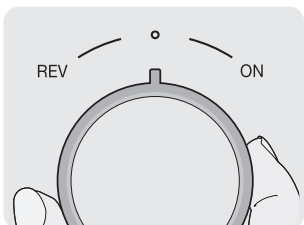

[○] : Stop - Press it to stop the operation of the product.

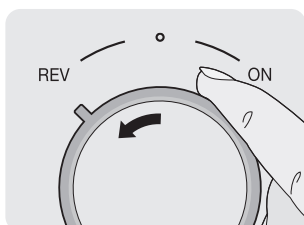

[REV] : REV - Press when the production halts while in use due to material overload. ※ It only works when the dial is being turned, and it stops when the dial is released.

4. Precautions for strainers

※ When you prepare juicing ingredients, choose your own proper ingredients if you have any food allergy.

※ Refer to the ingredient preparation guide and choose the right strainer type accordingly.

※ Please refer to the recipe book for how to use the product and tips for different ingredients.

※ Juicing ingredients should be cut small enough for the hopper. When you want faster or large juicing process, chop up ingredients a bit smaller. For every 1 kg extraction, repeat the "disassemble and rinse" cycle.

※ Do not overload ingredients into the hopper above the guided limit mark.

※ Fine strainer for soft fruits may cause pooling in the chamber.

※ Coarse strainer for fibrous fruit vegetables may cause thick juice extraction.

※ Ingredients to avoid: Inserting the following ingredients may cause product damage or breakdown.

- Unjuiceable ingredients such as sesame seed, coffee bean, Chinese pepper, tree bark, or pine leaf. Mudfish, eel, shrimp, marsh snail, squid, etc.
- Do not use fruits soaked in alcohol, honey, or sugar (e.g., grapes, raspberries, or mulberries) and herbal ingredients (e.g., glasswort or rock pine enzymes).
- Any ingredients that are unjuiceable in nature such as autumn olive, aloe, cactus, quince, banana, yam, kudzu root, sugar cane, acorn, dandelion
- Boiled ingredients such as boiled potato, sweet potato, bean, etc.
- Do not use this product for grinding grains.
- Frozen ingredients

※ Please refer to <2.Cautions during Operation>. (refer to 5P)

4-1. Coarse strainer (orange)

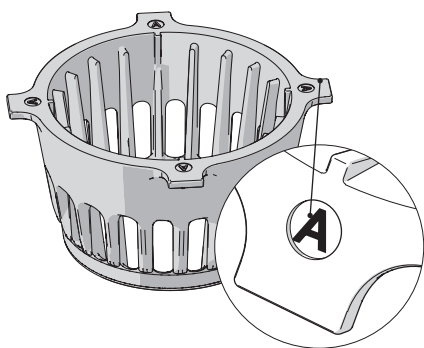

- Use it for extraction of general fruits and vegetables.
- Strainer mark: It is translucent orange and has strainer mark [A] on its hook.

Citrus fruits

Grapefruit, orange, lemon, etc.

Peel outer skin and cut the fruits into small size for the hopper chute. Remove all the hard, unchewable seeds or pits before insertion.

Fruits with thick rind

Pineapple, dragon fruit, melon, watermelon, pomegranate, etc.

Peel outer skin and cut the fruits into small size for the hopper chute. Remove fruit seeds that are hard to chew before insertion.

Fruits with hard seeds

Grape, apple, peach, persimmon, plum, cherry, pear, Korean melon, etc.

Use flesh only after removing hard, unchewable hard part of fruit, such as a peach pit. Hard seeds cause the product to halt while in use and may damage the product components. Remove apple seeds, if possible, as they can be toxic when ground. For grapes, pluck each grape from the bunch after rinse. Do not use too soft ingredients alone, but instead insert them with other fruit vegetables.

Fruits of soft, juicy texture

One-Ingredient Extraction (berries, cherry tomatoes, pineapples, etc.)

※ After cleansing, cut the ingredients into small pieces for the hopper hole. Remove stalk ends from the fruit vegetables.

Mixture Extraction (strawberry, kiwi, banana, tomato, mango, etc.)

※ For dry and viscous ingredients, mix with other ingredients for juicing. Remove the rind and stalk in advance. Remove mango seeds.

4-2. Fine strainer (black)

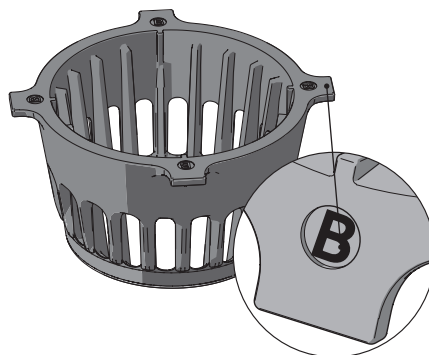

- Use this strainer for juicing fibrous roots, stalks, or leafy vegetables.
(Use the coarse strainer for general fruit vegetables.)
- Strainer mark: The strainer is black and has a strainer mark [B] on its hook.
- As some ingredients need extra care in trimming, please refer to the preparation guide below.
- When juicing several times or in bulk, cut ingredients smaller pieces, repeat "extract, disassemble, and clean" cycle, and empty out the pulp container frequently.
- For even faster process, cut ingredients into smaller pieces as well.

Root vegetables

Carrots, beets, ginger, yam, potatoes, garlic, etc.

Make sure to wash dirt and debris off the roots with running water. Peel outer skins of fibrous ingredients such as ginger, and cut long ingredients into sticks for extraction.

Leaf • stalk vegetables

Celery, kale, cabbage, watercress, wheat sprout, chives, etc.

Cut the ingredients into 3 cm or shorter pieces for extraction. As leaf stalk vegetables are rough and fibrous, they are not squeezed well, or the screw can get tangled.

※ Find a strainer for root, leaf, stalk vegetables cause pooling in the chamber. Please use the coarse strainer.

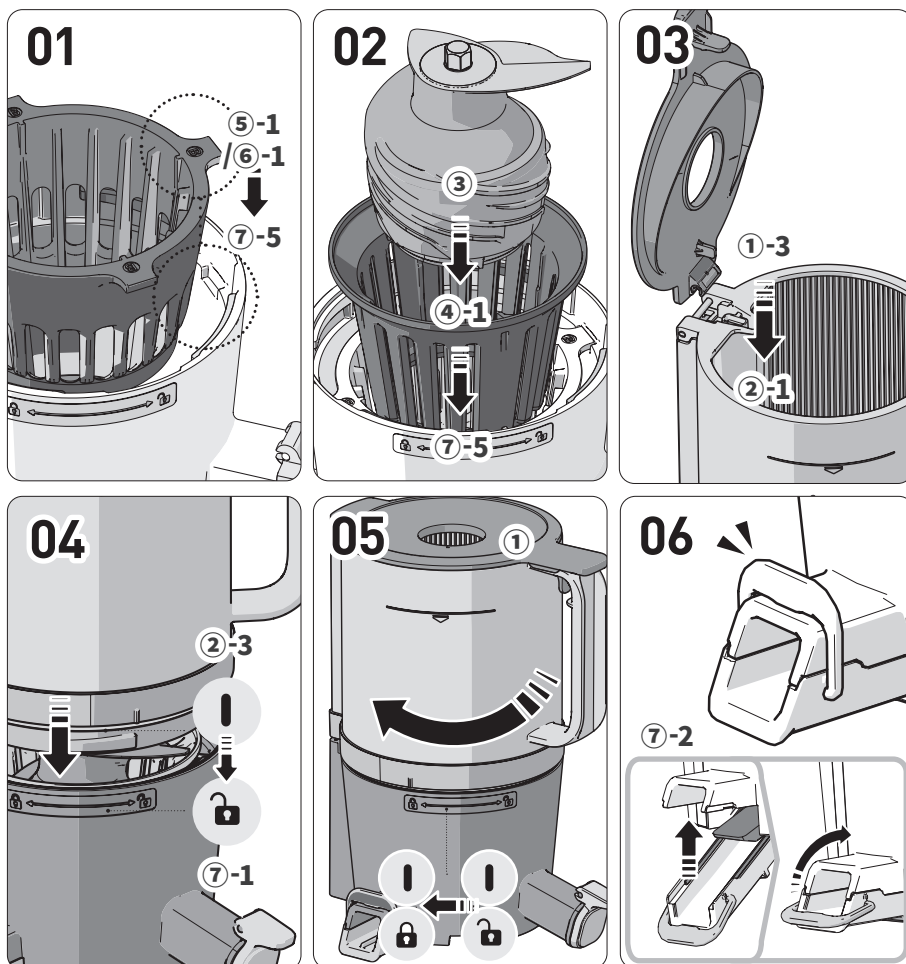

01 Make sure to align groove in the chamber(7-5) external strainer wing(5/6).

02 Assemble the inner strainer and squeezing screw onto the external strainer of chamber.

The settlement point of the inner strainer (4-1) and the wing of outer strainer (5-1 / 6-1) should be aligned in place.

03 Place the hopper lid (1-3) vertically onto the hopper (2-1).

04 Align the guide mark (7-1) of the hopper [] with the guide mark (2-3) of the chamber [].

05 Turn the assembled hopper clockwise until its guide mark is aligned with the guide mark [] on the chamber.

If the internal components are not assembled correctly, the hopper will not close properly.

06 Make sure the discharge cover (7-2) of the chamber is properly fastened with the loop.

1. Close the discharge cover and fasten it with the loop.

2. If the silicone parts are not plugged in place, or the lever is not fastened, juice may leak or the lever may open during extraction.

07 Place the well-assembled chamber set onto the base.

※ Silicone packings are supposed to be replaced every 6 to 12 months. You can purchase them through our Customer Service Center.

(The juicer may leak if the product is not assembled properly.)

Extraction Packing

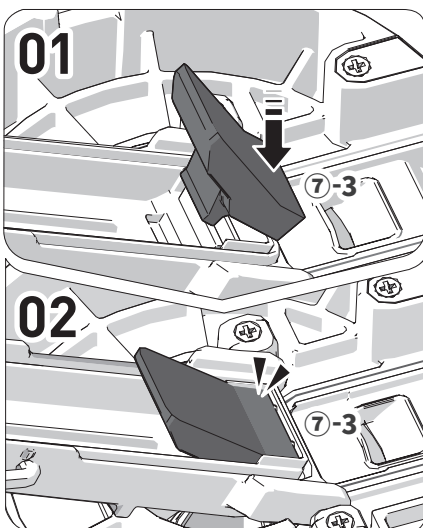

Seal Packing

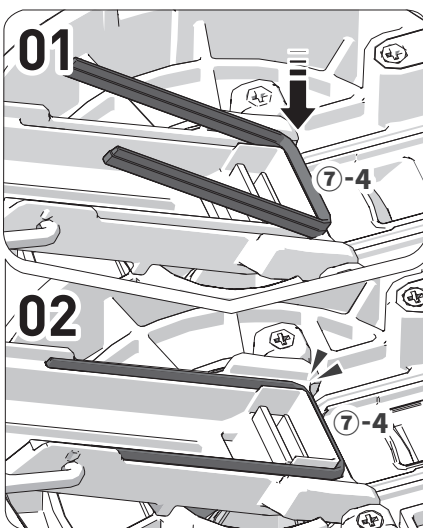

- 01 Hold the silicone ring and pull it out smoothly.
- 02 After cleaning, plug the silicone ring upright into the slot by fixing one end into place first.
- 03 Insert the rest and press down firmly.

Juice Cap Packing

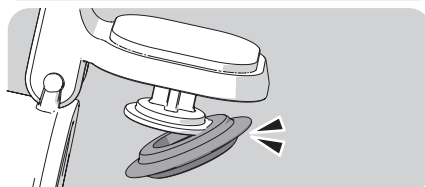

- 01 After washing, fit one side of the packing first like a hook.

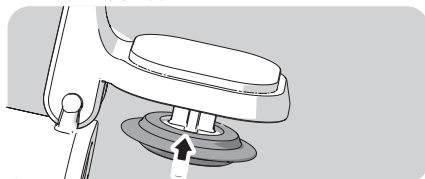

- 02 Fit the rest and push it in around the rim.

Hopper Packing

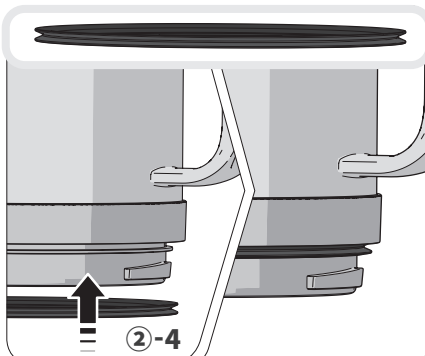

Assemble the packings as shown in the figure.

Chamber Packing

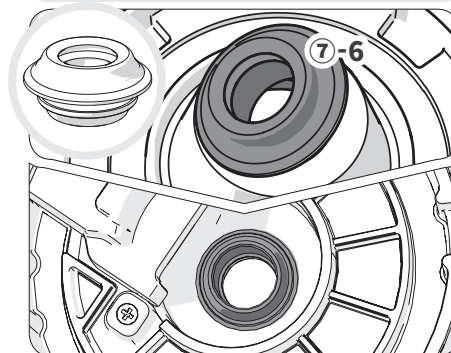

- 01 Grab onto one side and pull out.
- 02 After cleaning, plug the silicone rings upright into the slot as if it is hanged one side first.
- 03 Press the rest of packing down along the slot in place without any folded part.

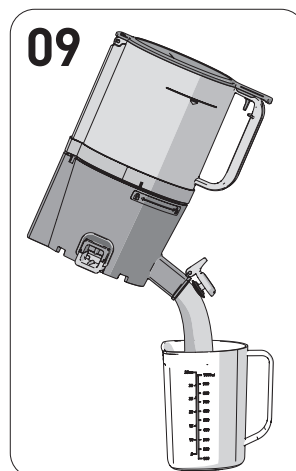
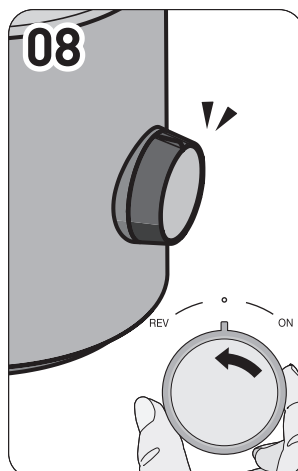
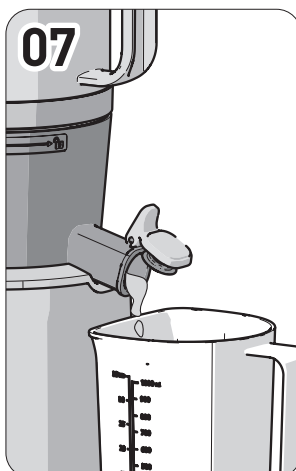
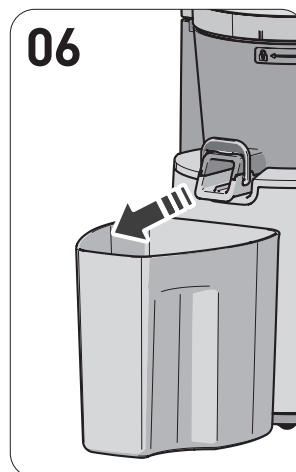
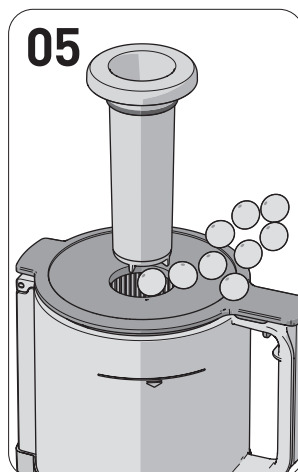
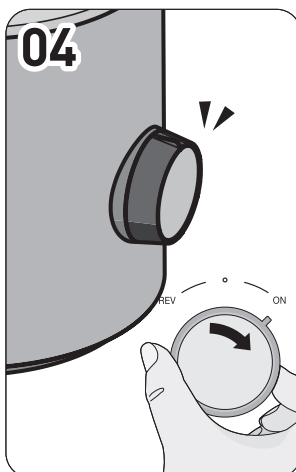
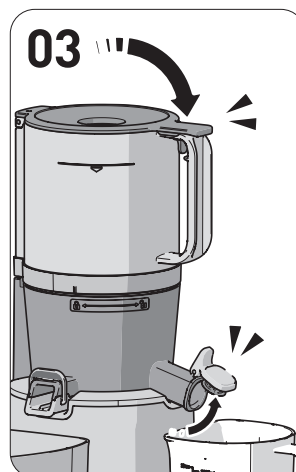
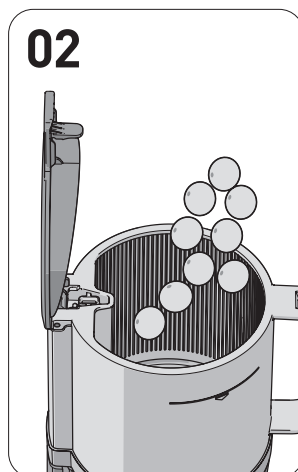
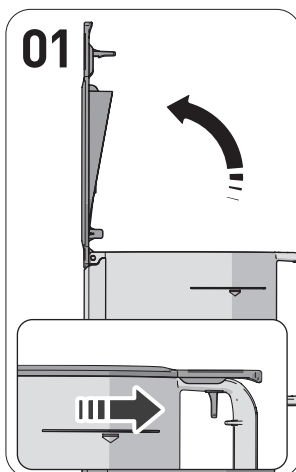

8. When the squeezing screw stops during normal operation

11

English

01 Pull up the lever inside the hopper knob and open the lid.

① Pull up the lever inside the hopper knob, and open the lid. Overloading the product with ingredients may damage the product.

02 Insert juicing ingredients below the limit mark of the hopper.

① Use watery soft ingredients after mixing them with others.

② When juicing a high volume of ingredients, frequently empty out the chamber and pulp cup.

03 Close the hopper lid, and keep the juice cap open.

① Before turning the juicing dial, position the juice cup first.

② The juice can flow backwards into the hopper if the juice cap is closed. If the juice doesn't empty even after opening the juice cap, open the hopper lid and remove the contents.

04 Turn the power dial [ON] to start operation.

① "Clicking" sound upon starting is made when the chamber set fits with the motor.

05 If you want to add more ingredients during operation, use the add door on the top or open up the hopper lid.

① Operation stops when the hopper lid is open.

② Do not use any other voltages other than the designated one.

③ When the screw spins and the ingredients are not being ground, use the pusher to push down ingredients.

06 Empty out the pulp container and juice container so that they are not filled up.

07 Let the product run for another minute or so after the last ingredient goes down through the hopper.

① It takes some time for the last piece to be extracted as it is pressed down the product slowly.

② Run the appliance after the extraction to send out residual pulp, and it will be easier to disassemble and clean the hopper.

08 Once the extraction and release of residue is done, switch off the juicer.

① The juicer stops 3 seconds after it is switched off.

09 Pour any juice left in the product by tilting the chamber set forward.

① For thick juice like tomato juice, it is likely to pool in the chamber set.

01

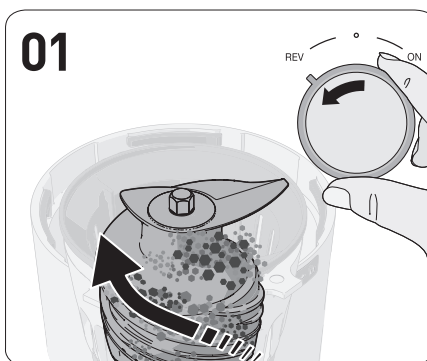

02

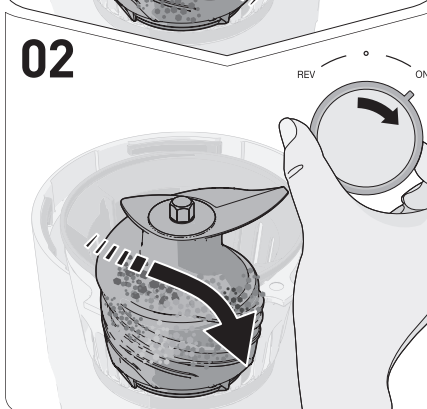

01 For 2 to 3 times, repeat the process of maintaining the state in which the power dial is turned to the [REV] direction for 3 to 5 seconds and then releasing the dial.

The reverse rotation is a function that returns and lifts the ingredients upward. It only works when the dial is being turned, and the screw rotation stops when the dial is released.

02 After the screw is completely stopped after reverse rotation, turn the power dial to the [ON] direction (clockwise) to start the operation again.

When pressing the [ON/Extract] or [REV/Reverse] button, make sure to press it after the screw stops moving completely.

Precautions

If the juicer does not work after these steps, unplug the appliance, and disassemble and clean the parts before operating the juicer again.

The motor will continue to spin after the machine is turned off, but it will slow down and come to a complete halt.

12 9. How to Disassemble and Clean

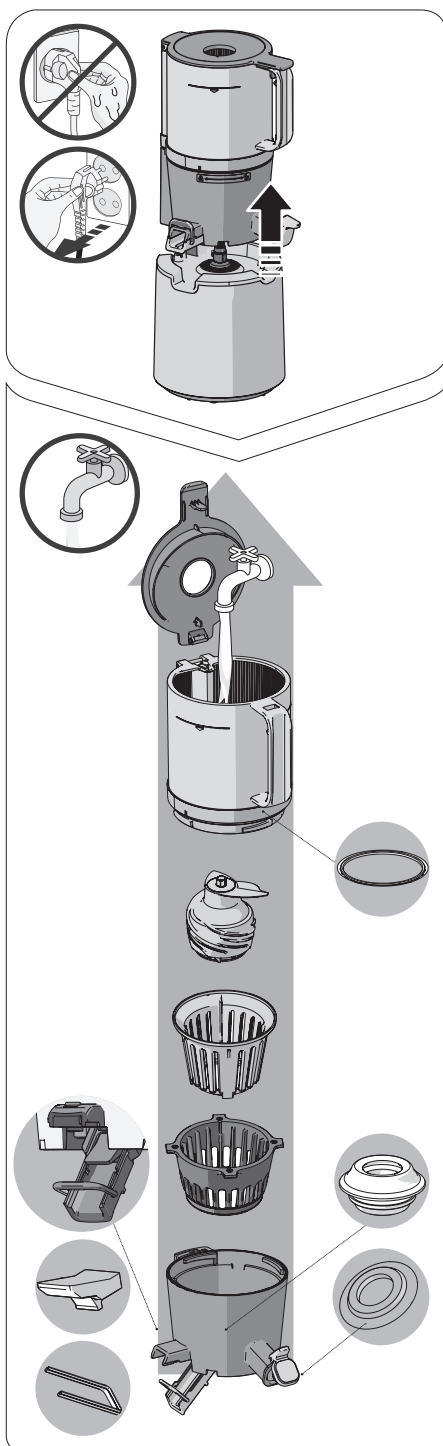

※ After the product stop operating completely, unplug the power cord with your dry hands. The motor is still slowing down after the appliance is turned off, so wait about 3 seconds before separating the chamber.

- 01 Separate the chamber set from the base. Turn the hopper open and pull off the parts in order.
- 02 Wash the parts under running water with the cleaning brush.
- 03 Wash the chamber with the pulp outlet cover and the juice cap wide open.
- 04 Wipe the base with a dry towel or soft cloth.
- 05 For silicon rings, detach and wash them after use. -There may be juice residues stuck in. (Hopper ring, juice cap, extraction cap, sealing, and chamber ring)
- 06 You can sterilize the parts by soaking them in warm water with baking soda, citric acid, or vinegar.

※ Be sure to clean and air dry the appliance completely after use and store it at a clean place. Failure to clean the product right after use can cause its stainless steel components and other parts to corrode or discolor due to salt and pulp of the ingredients. In addition, contaminants may dry up and get stuck inside the product, making disassembly or cleaning difficult or adversely affecting the product's performance. For long-term storage, clean the appliance with the cleaning brush in advance. Do not clean the product with boiling water or subject it to high temperature. Do not use abrasive cleaning tool like kitchen sink cleaner, or stainless-steel sponge. Do not use a dishwasher or dish dryer for the product.

※ Residue can be easily removed by washing and shaking it with clean water inside.

10. Before Requesting Repair

Check the following before asking for repair. For follow-up service and any inquiry you may have while using the product, please contact our Customer Center, or homepage at <http://www.globalhurom.com>. Check the manufacturer's number or the number under the barcode when requesting for follow-up service or parts.

English

01. When the product starts operation, it will make a "clicking" sound.

This is the sound of when the motor and the squeezing screw are connected. and not a sign of malfunction.

02. The product won't operate with the main body only.

Make sure the chamber set and main body are assembled properly. Ensure the product is unplugged before assembling or disassembling it.

03. Align the safety sensors.

Make sure they are assembled in accordance with the assembly guide. Ensure the product is unplugged before assembling or disassembling it.

04. The product does not work.

Check if the power cord is plugged properly.
The machine may not work after prolonged use (30 minutes or longer). It will resume normal operation once the main body (motor) cools down.
Check if the hopper fits properly. If the hopper is connected incorrectly, the product will not operate properly. It will operate only when the lock symbol on the chamber is perfectly aligned with the assembly guide on the hopper (②-3). Ensure the product is assembled in accordance with the assembly guide. Refer to the assembly page 8 of the instruction manual.

05. The product suddenly stops running.

Is the hopper overloaded with juicing ingredients, or are the ingredients too big? Refer to the manual page 11, and activate reverse rotation.

06. There are cracks on the screw and scratch marks on the upper part of the screw.

In addition to the straight molding marks on the top and sides of the screw, there are curved marks that were created while it was being molded. These marks are normal and they have no impact on your use of the screw.

07. Juice leaks through the pulp outlet immediately upon inserting ingredients.

A little juice may come out of the pulp outlet depending on the ingredient. This is not a product defect but the result of the characteristics of the ingredient. The leakage will stop once the product starts running. If the leakage persists, contact our Customer Service Center.

08. Juice flows back into the hopper.

Did you operate the product with the juice cap closed? Closure of the juice cap may cause a back flow up to the hopper. If the flow gets clogged even after opening the juice cap, open the hopper lid and empty out the inside.

09. Juice leaks between the hopper and the chamber, or between the chamber and the main body.

Is the hopper silicone ring assembled correctly? Juice will leak if the chamber silicone ring has been assembled upside down or incompletely. Check if the silicon rings have been assembled correctly.

10. I can't open the hopper.

There may be excessive pulp remaining inside. If the remaining pulp is discharged by turning on the machine, or the machine is rotated in reverse for 10 seconds two or three times, the hopper will open smoothly.
Perhaps you put foreign or solid substances (hard seeds such as persimmon seeds)? If you have put foreign or solid substances, attempting to run the product in reverse direction may further damage the component. Thus, contact our Customer Service Center and request after-sales support.

11. The chamber is vibrating (during juicing).

The product may wobble slightly due to the vibrations produced by the main body's motor. It may vibrate depending on the ingredient's hardness or toughness. This is not a malfunction but a normal sign as it is caused by the rotating screw. The product may seem to vibrate more when juicing solid ingredients (e.g., carrots, potatoes, radishes, beets, or kohlrabies) than when juicing soft and watery ingredients. (e.g., carrot, potato, radish, beet, kohlrabi, etc)

12. Pulp outlet is covered, but the pulp comes out.

Even if the lever is closed, pulp may still come out naturally. The velocity and amount of pulp discharge may differ according to the ingredients used.

13. An unusual noise is heard while juicing.

This is a natural sound when the ingredients are being crushed. If the ingredients are hard or tough, such as apples, carrots, cabbage, celery, beets, and so on, the noise may be louder than when juicing softer ingredients.